



**Zakład Narzędziowy
"PZL-Dębica" Sp. z o.o.**

YOUR ASSISTANCE IN MANUFACTURING PROCESSES



www.zndebica.pl

WHO ARE WE?

ABOUT THE ORGANIZATION

Zakład Narzędziowy "PZL - Dębica" Sp. z o.o. in Dębica has been an independently operating entity since 1997, having been established as a separate entity from Wytwórnia Urządzeń Chłodniczych "PZL-Dębica" S.A. in Dębica.

We possess extensive experience in the production and regeneration of cutting tools, the manufacturing of technological equipment, and the creation of custom spare parts crafted according to supplied documentation.

Throughout the years of maintaining exceptional quality, we have served a diverse array of clients in the aviation, automotive, rubber, furniture, and various other industries.

Our extensive experience and enduring collaborations with both Polish and international partners ensure that our products meet the highest quality standards. Since 2007, Zakład Narzędziowy "PZL-Dębica" Sp. z o.o. has established a quality management system in accordance with ISO 9001:2015 for the design and production of metal products.

ACTIVITY



Design and implementation of mechanical assemblies, precision engineering, both numerical and conventional machining, fabrication of mechanical and welded assemblies, and production of products customized to client specifications.



Thorough collaboration with each industry sector. Advanced machinery capable of managing even the most challenging projects.



Manufacture of specialized devices and tools, production of small and large "Prototype" series.



QUALITY ASSURANCE

Our company prioritizes quality control in machining, guaranteeing the utmost precision and repeatability of manufactured components. We utilize advanced measuring equipment, including coordinate measuring machines (CMM), micrometers, and various other inspection tools. Each phase of production undergoes stringent control procedures, enabling the elimination of errors and adherence to the highest quality standards.

We possess certificates that affirm the alignment of our processes with international standards, ensuring reliability and complete adaptation to customer requirements. As a result, we are able to provide products of the highest quality, satisfying even the most stringent technical specifications.



TEAM

Throughout the 28 years of our company's operations, we have assembled a team of experts in project machining and quality control. We employ more than 90 specialists, each possessing extensive experience. Our production capabilities and industry knowledge enable us to continuously evolve and respond to market changes. We are consistently broadening the range of services we offer.



PRODUCTION

MACHINERY FLEET

Our machinery fleet comprises state-of-the-art equipment that adheres to all standards and specifications. This ensures the highest quality and efficiency, enabling us to manufacture products customized to meet the unique needs of each client.



MATERIALS PROCESSED

- ➔ Tool Steels Quality
- ➔ Steels Aluminum
- ➔ Alloys Stainless
- ➔ Steels Titanium
- ➔ Alloys
- ➔ Non-Ferrous Metals
- ➔ Polymers

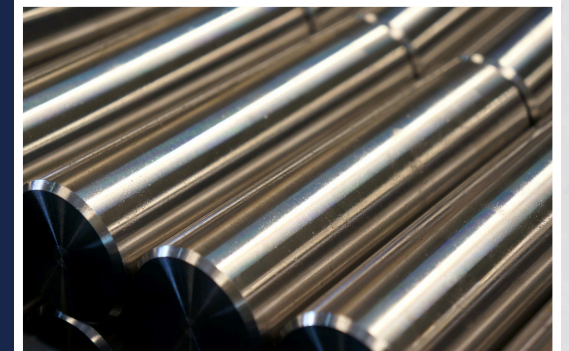

OUR PROPOSITION

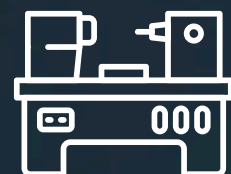

TURNING

Lathe: Ø320 x 700 mm

Lathe: Ø350 x 1000 mm

Lathe: Ø350 x 1500 mm

Lathe: Ø500 x 3000 or Ø900 x 500

CNC Lathe: Ø400 x 1100 mm

CNC Lathe: Ø1100 x 3000 mm

CNC Lathe: TK 400, 150 x 300 mm



MILLING

Milling machine: 360 x 430 x 400 mm

Milling machine: 380 x 380 x 400 mm

Milling machine: 360 x 600 x 400 mm

CNC milling machine: 600 x 430 x 400

CNC milling machine: 790 x 590 x 490

Milling machine: 1000 x 4500

Milling machine: 1000 x 4000

Milling machine for long taps:

Ø200x2000mm CNC milling machines

CNC milling machine:

600x430x400mm CNC milling

machine: 790x590x490mm 5-axis CNC
milling machine Ø400



GRINDING

Cylindrical grinder: Ø200 x 200 mm,
Ø200 x 700 mm, Ø200 x 1200 mm.

Internal grinder: Ø160 x 160 mm,
Ø200 x 200 mm, Ø300 x 400 mm.

Bench grinder: 200 x 600 mm, h = 200
mm; 200 x 600 mm, h = 300 mm; 200 x
600 mm, h = 200 mm; 250 x 500 mm, h
= 280 mm; 300 x 1000 mm, h = 300
mm.

Shaft grinder: Ø260 x 1000 mm and
Ø180 x 200 mm.

CNC grinder: 1200 mm x 600 mm x
300 mm. Coordinate grinder



BORING

Boring machine: 2500 x 3000 mm

Boring machine: 1100 x 1500 x 900
mm and 1000 x 1000 x 900 mm

Coordination boring machine:

400 x 200 x 450 mm, 600 x 300 x 400
mm, 900 x 500 x 400 mm

5-axis CNC boring machine: 1000 x
1000 x 1300 mm



ELECTRO-DRILLING

Wire EDM apparatus:

Working area: 500 x 500 x 300 mm

Working area: 1,270 x 800 x 435

Working area: 450 x 320 x 410 mm



LASER SERVICES

LASER FOR PIPES AND PROFILES:

Ø200 x 6000 mm

LASER FOR SHEET METAL: 6000 x 2000 mm

LASER MARKING

LASER WELDING

TIG, MIG/MAG welding, brazing, hydraulic press 250MPa, hardening, blackening and polishing, chiseling, CNC welding, powder coating



COMPLEXITY

We execute projects from design to implementation in production. We offer services for various industries, including:

- ▶ Aviation
- ▶ Tire
- ▶ Railway
- ▶ Wood
- ▶ Military
- ▶ Metallurgical
- ▶ Metallurgical
- ▶ Construction
- ▶ Transport
- ▶ Food

THEY HAVE CONFIDENCE IN US:

- ▶ Pratt&Whitney
- ▶ Safran
- ▶ KRONOSPAN
- ▶ TC Dębica
- ▶ SILVA
- ▶ PKP PLK
- ▶ Delonca Concept
- ▶ JV Group
- ▶ Goodyear Dunlop Europe
- ▶ United Technologies
- ▶ Ford
- ▶ Significantly more





Treatment

We specialize in the mechanical processing of various types of metals and plastics.

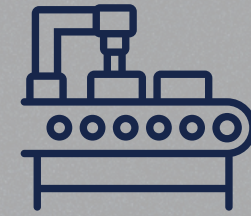

Intralogistics

We provide solutions for production lines. We design and develop in-plant transportation systems.

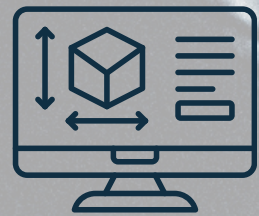

Device Design

Our design office undertakes industrial design projects for devices based on client specifications.



Small-scale manufacturing

We provide the manufacturing of custom components, including the most intricate designs.

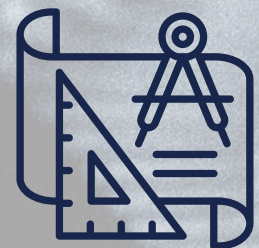

Measurement services

Our measurement laboratory, outfitted with state-of-the-art equipment, guarantees product quality.



Mass production

We are capable of producing consistent components on a large scale.



Machine Engineering

We provide comprehensive machine construction services for the industry, encompassing everything from design to implementation.



Guarantee

We offer a guarantee on our products, demonstrating their quality.



OUR OFFERINGS

Our company manufactures high-quality machinery and production lines tailored to diverse industries. We have established systems for transporting tires, packages, and comprehensive production lines. Our emphasis is on robust construction, reliability, and precision in craftsmanship, ensuring the longevity of our solutions. We offer advanced technologies that enhance efficiency and automation in production.

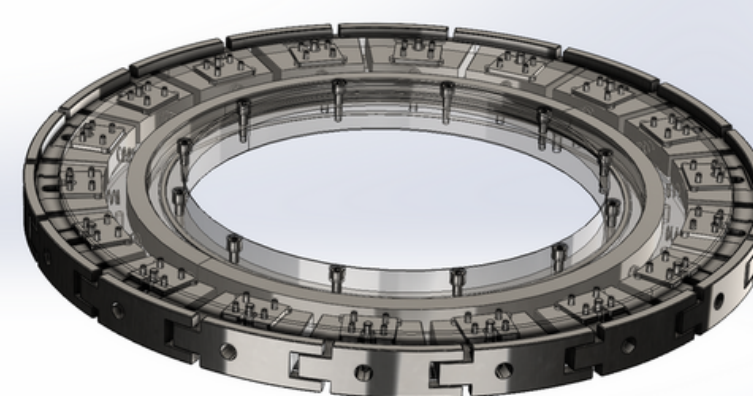
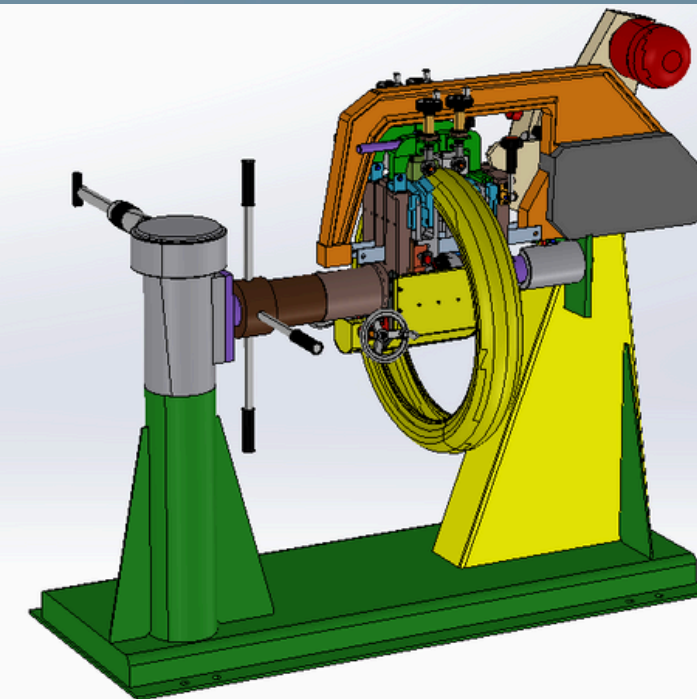
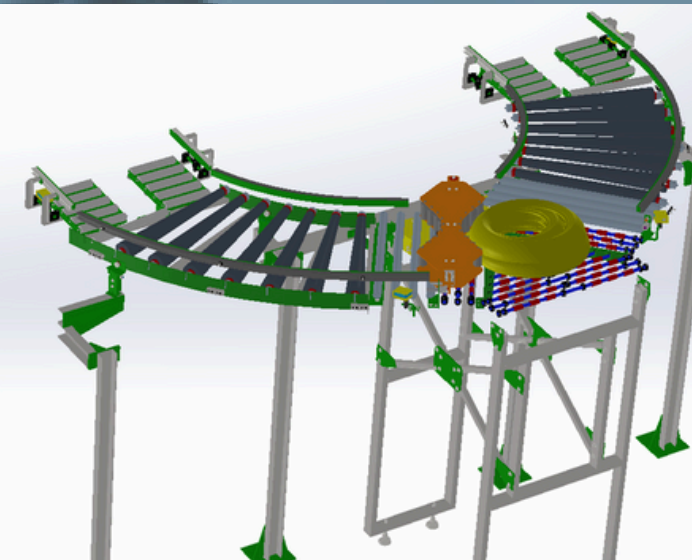
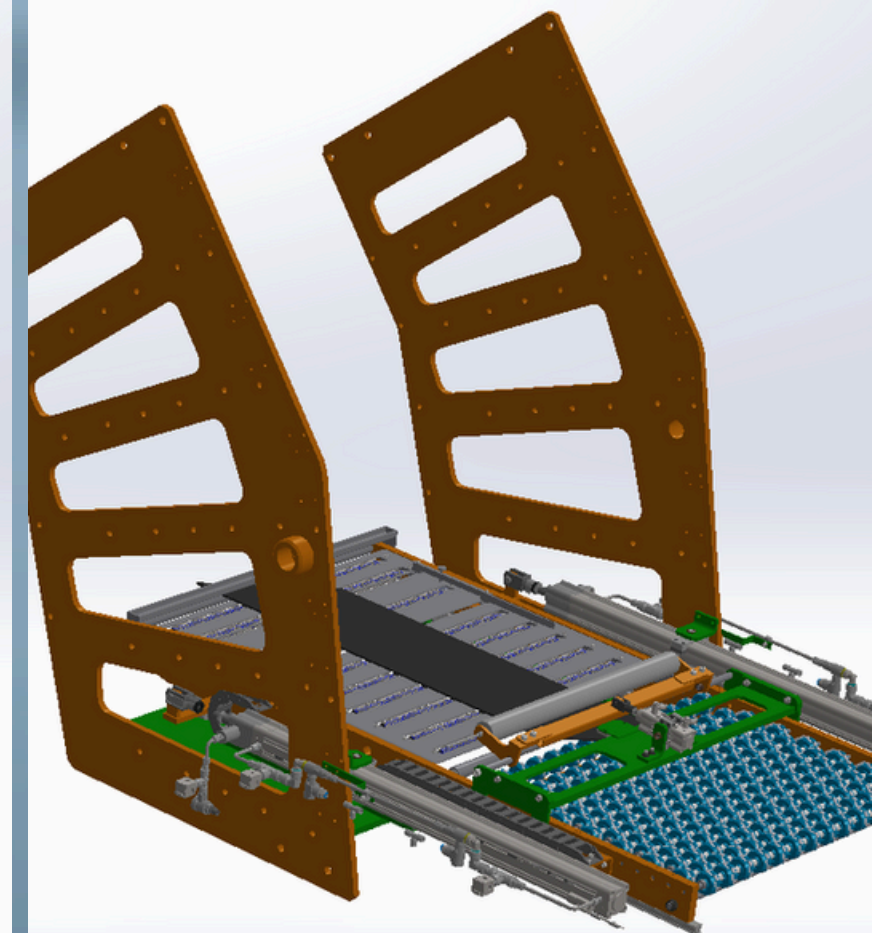
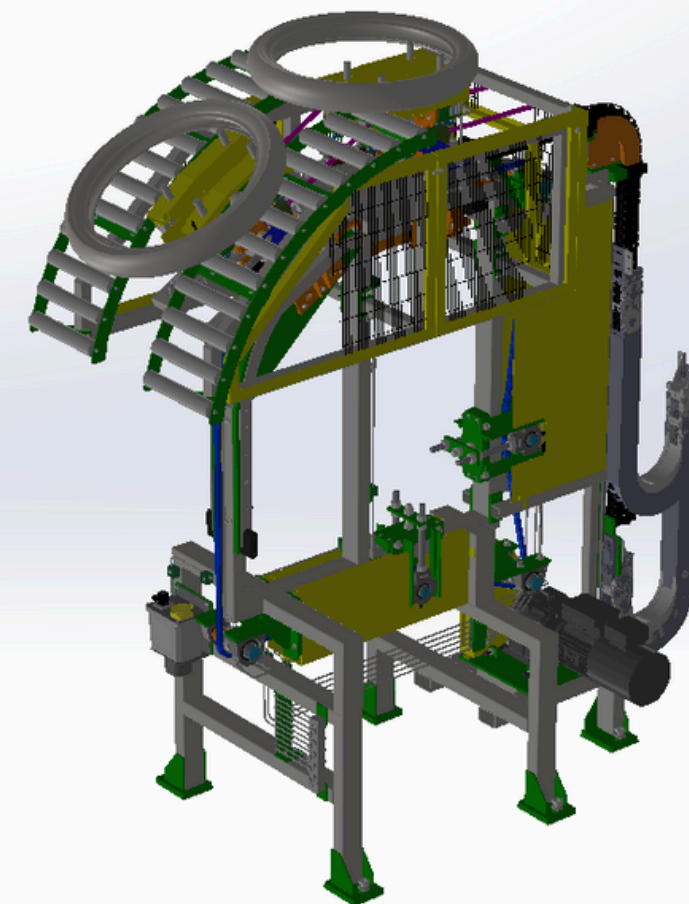

- ✓ **Robust construction**
Our machines are constructed from robust materials, ensuring their longevity and resilience under intensive use.
- ✓ **Adaptation to customer needs**
We design and manufacture machines tailored to your specific requirements, facilitating seamless integration into existing processes.
- ✓ **Automation and efficiency**
Our solutions enhance production processes, improving efficiency and lowering operating costs.

OUR OFFERINGS

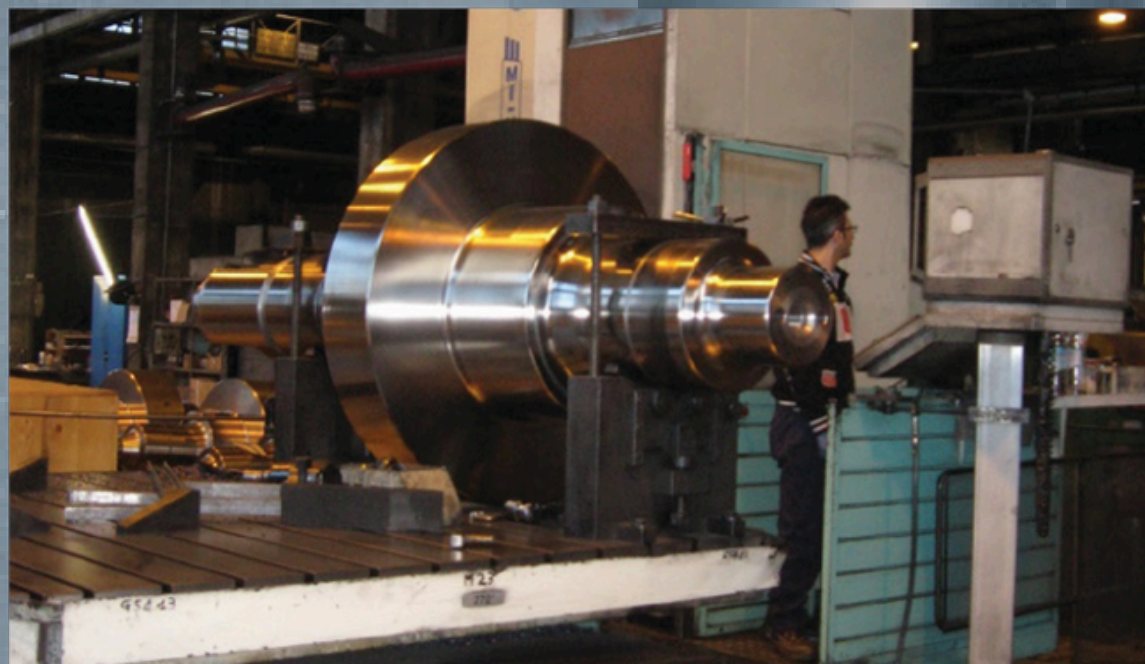

Element for manufacturing lines in the furniture industry

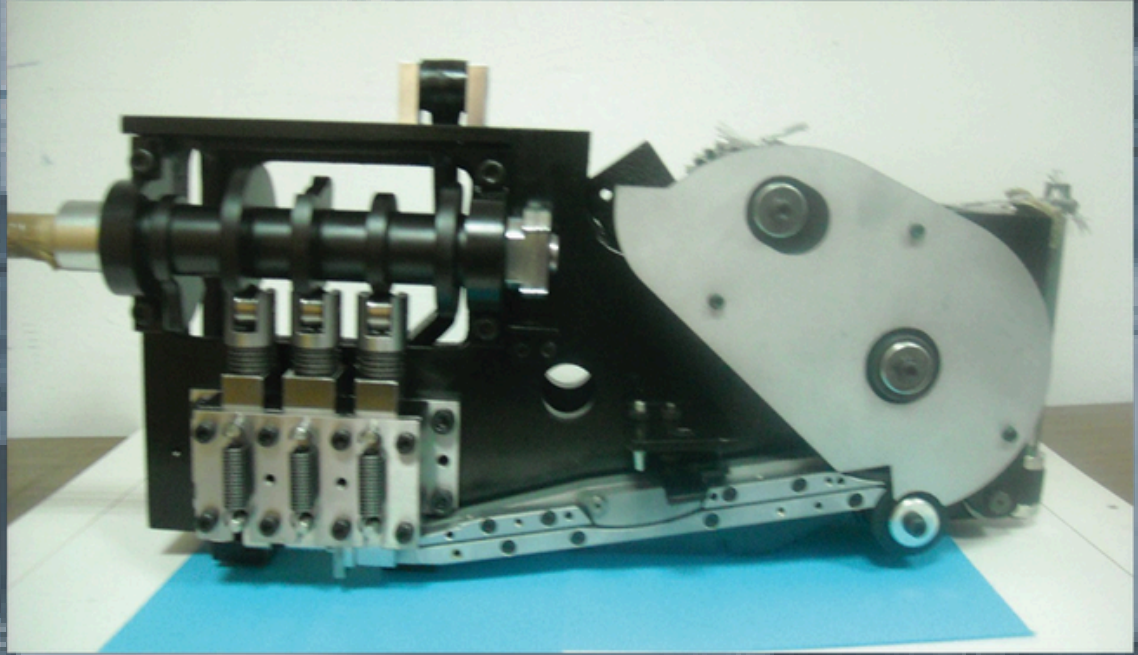

Packaging machine assembly



Transport Solutions for the Tire Industry

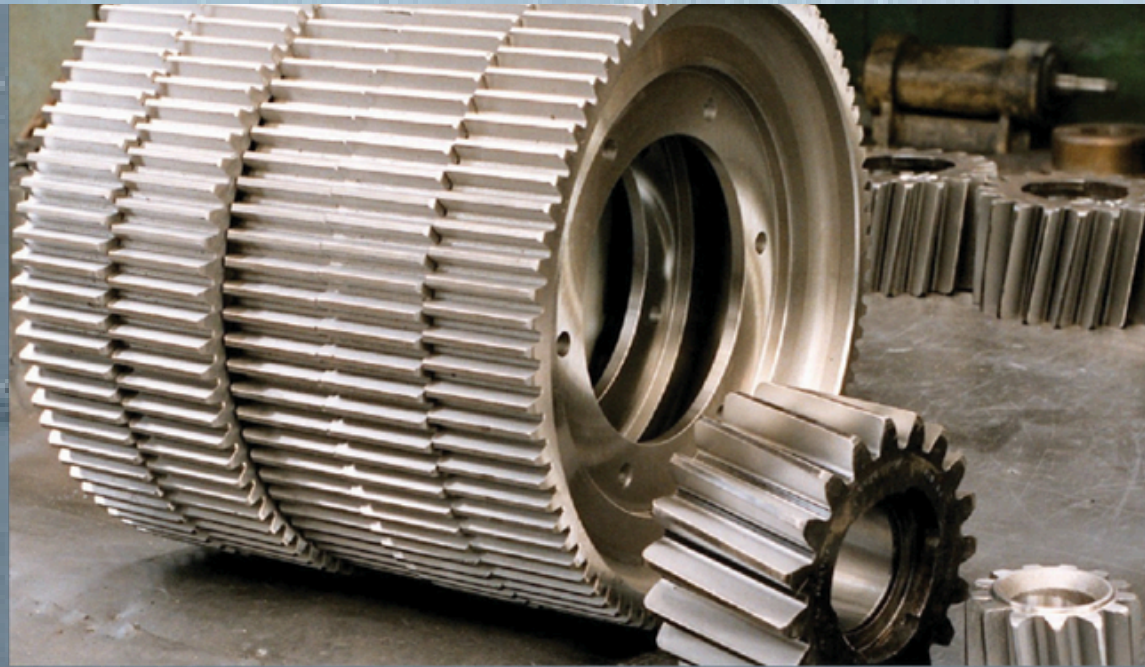

Intricate gears



Measuring devices for the aviation sector



Swivel Jaws on CNC Machining Center

OUR OFFERINGS

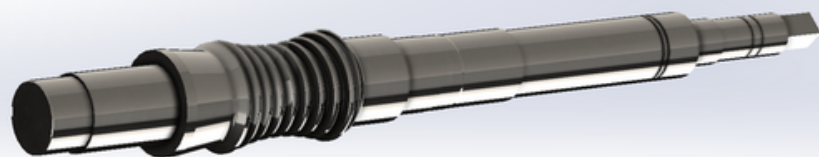

**Globaloid
Snail**

automobile sector

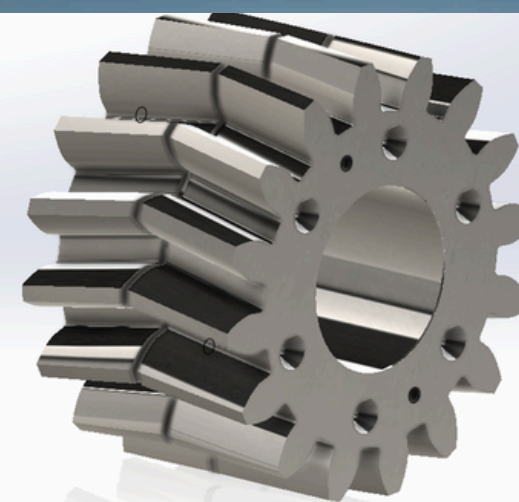

**Arrow
wheel**

automobile sector

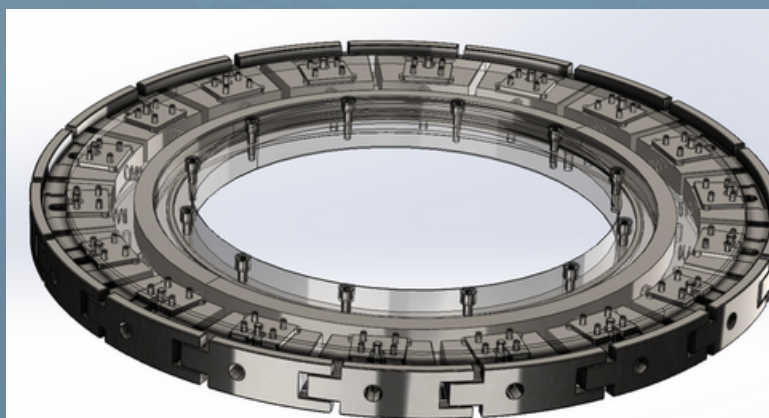
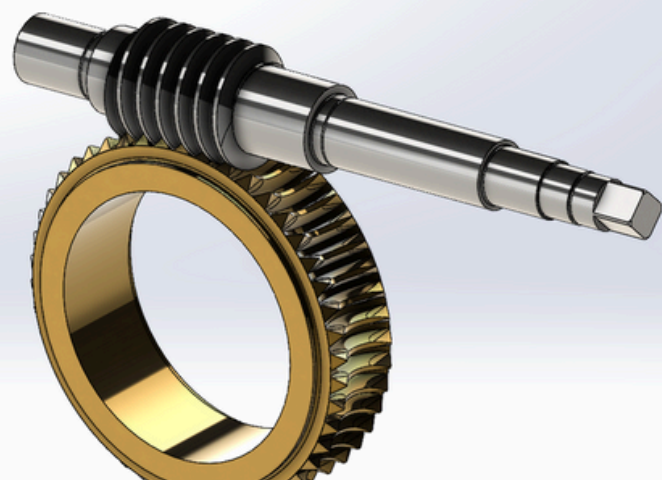

**Collection of
expanding
segments**

tire sector

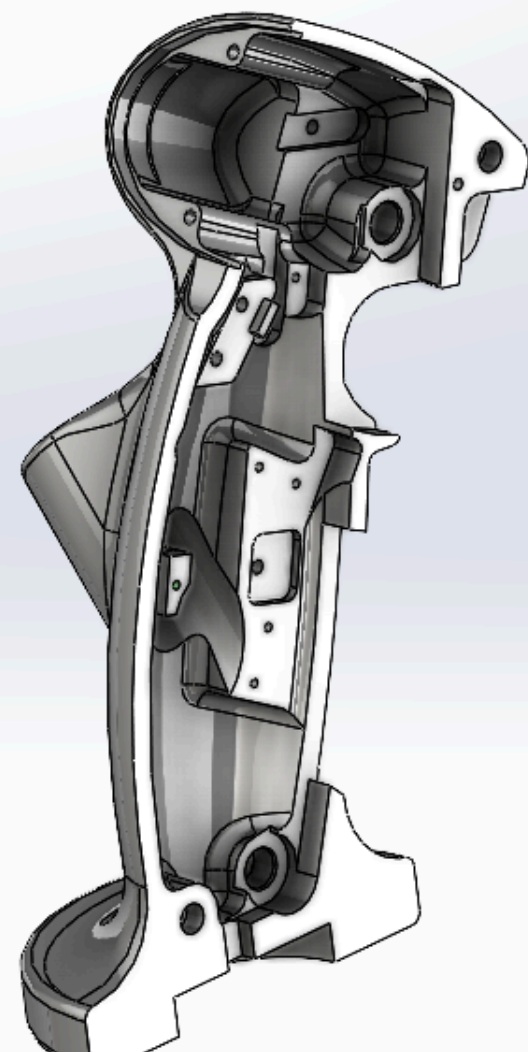

**Control
joystick**

aviation sector

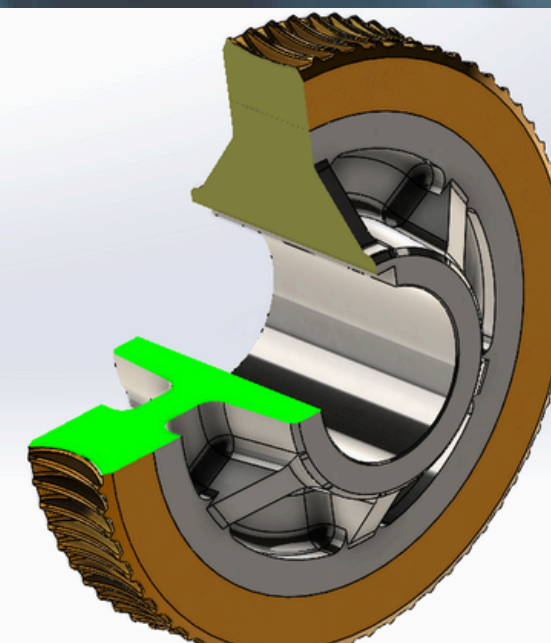

Globoid worm

tire sector



**We provide products that fulfill
your expectations.**

Our company is a trusted partner in the industry, recognized for its exceptional craftsmanship, prompt order fulfillment, and adaptable customer service. We collaborate with major corporations, delivering dependable solutions. We assure complete satisfaction with our products. We invite you to partner with us—together, we will develop innovative and effective solutions tailored to your requirements!



PRESIDENT:
Krzysztof Potyrała
LEGAL FORM: Limited Liability
Company
DATE OF ESTABLISHMENT:
1997 CAPITAL: PLN 1,098,200
NIP: 872 15 37 958
CERTIFICATE: ISO 9001:2015



Zakład Narzędziowy „PZL Dębica”

We ensure accuracy, consistency, and reproducibility.
punctuality and superior quality.

